



MANUAL LIFT KIT

For 15-0001 Cycle Country Standard Push Tube

ASSEMBLY / OWNER'S MANUAL

Part No: 15-0015

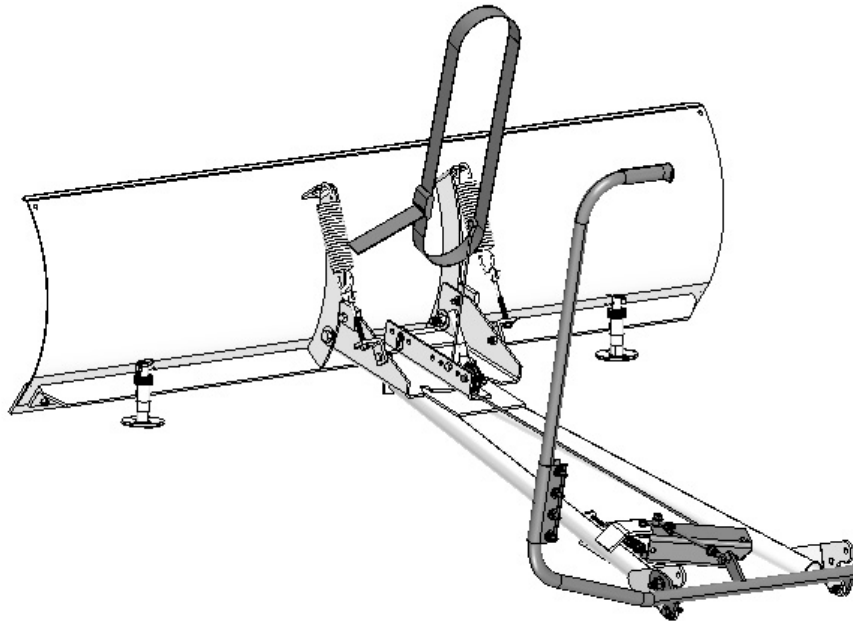

OPERATING INSTRUCTIONS

Congratulations! You've just purchased the most durable plow component in the industry. Cycle Country plow components work great for summer or winter plowing. With proper care and maintenance, your Cycle Country plow system will last for years to come!

NOTICE
Manual Lift Kits require additional components for operation*
Cycle Country Push Tube and Plow Blade
Cycle Country Mount Kit
<i>*These components may be specific to your vehicle. To find your specific application, use the 'Search by Vehicle' function at www.cyclecountry.com</i>

Please read and understand all assembly instructions, notices and warnings before assembling and operating your Cycle Country plow system.

Follow these guidelines to ensure satisfactory operation:

- Read this manual and your ATV operators manual before use. Follow all warnings and notices.
- The blade is raised by pulling back on the lift handle, or lowered by releasing the lift handle forward. The blade will lock into the 'up' position by pulling all the way back on the lift handle. Infinite height settings can be achieved by holding the lift handle at the desired position as you plow. For extended above-grade plowing, adjust the blade skids to the desired distance.
- This lift kit has a given range of movement, which is balanced between blade lift height and "float" (the amount the blade will move above and below grade). If you adjust the lift kit to achieve more blade lift, you will lose an equal amount of "float". The manner and terrain on which you will plow with your ATV may dictate what sort of balance is right for you.
- Operate with extreme caution on slopes and rough terrain. Be familiar with the area before you plow.
- Be aware of immovable objects that could be hidden in the dirt, gravel or snow you are plowing.
- To avoid damage when plowing dirt, gravel or snow into a pile, reverse direction before raising the plow blade.
- Do not ram the plow into piles of dirt, gravel or snow .
- Periodically check for wear and tightness of all fasteners. Replace or re-torque fasteners as necessary.
- Periodically grease pivot points as needed and as part of your end-of-season maintenance.

A complete operator's guide can be downloaded for free at www.cyclecountry.com. This guide contains beginner-to-advanced information regarding plow systems and operation.

SAFETY INFORMATION

Cycle Country plow systems were designed with your safety in mind. In order to protect you and your ATV, certain parts of the plow system and/or hardware are designed to fail when the equipment is over-stressed.

 WARNING
To avoid personal injury or damage to your vehicle:
Do not exceed 5 mph (8 kph) with the blade installed
Be aware that vehicle ground clearance is reduced with plow system installed
Keep yourself, other people and pets away from the blade and moving parts during operation

 WARNING
To avoid personal injury or damage to your vehicle:
While in operation, keep your leg out of the path of the lift handle. Lift handle may fly back, striking you.
Before adjusting blade angle or disconnecting the plow system, stop the engine and set the parking brake
Remove your plow system before trail riding

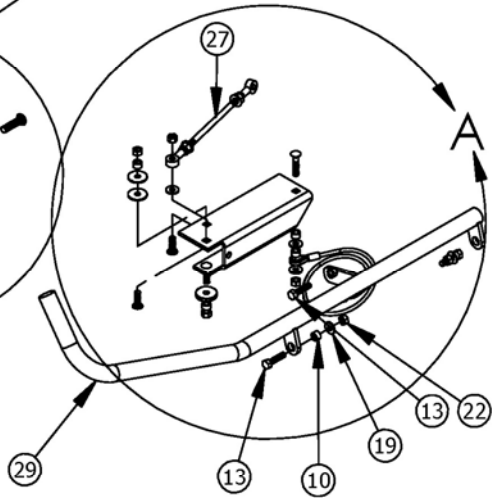
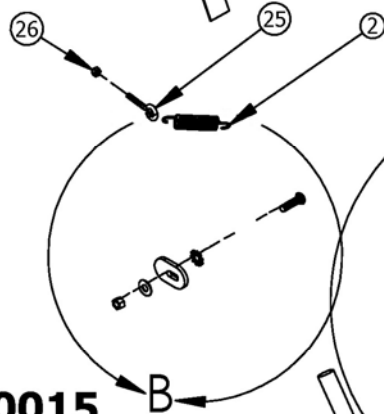
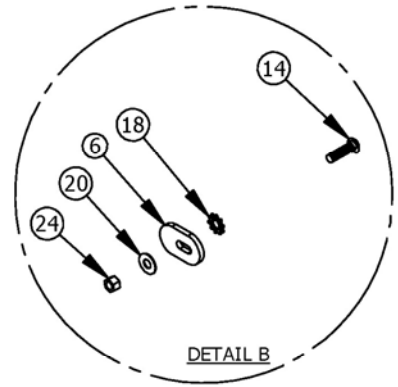
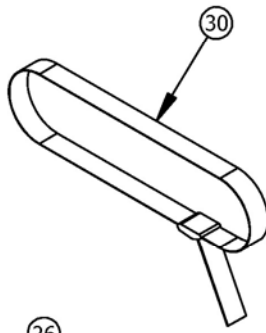
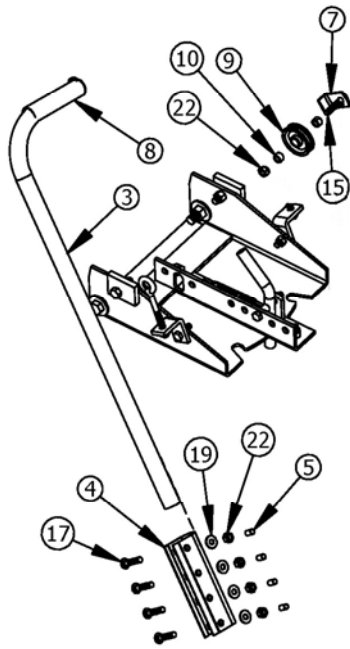

Model Number 15-0015 Parts List

ITEM NO.	QTY.	PART NO.	DESCRIPTION
1	1	CYC3146	Link Channel
2	1	PUR1437	Blade Position Spring
3	1	CYC3152	Lift Handle Tube
4	1	CYC3147	Lift Handle Tube Clamp
5	4	PUR1086	Thread Cap
6	1	CYC3144	Slotted Stop
7	1	CYC3145	Cable Guide
8	1	PUR1477	Handle Grip
9	1	CYC5747	Pulley
10	8	PUR1360	Roller Bushing
11	1	PUR1380	Spacer 5/16" x 1-1/4" x .2"
12	2	PUR1189	Carriage Bolt 5/16" x 1"
13	3	PUR1158	Bolt 5/16" x 1-1/4"
14	1	PUR1186	Carriage Bolt 3/8" x 1-1/2"
15	1	PUR1156	5/16" x 1-1/2" Bolt
16	1	PUR1191	Carriage Bolt 5/16" x 1-1/4"
17	5	PUR1190	Carriage Bolt 5/16" x 1-1/2"
18	1	PUR1400	Star Washer 3/8"
19	9	PUR1237	Flatwasher 1/4"
20	1	PUR0250	Flatwasher 3/8"
21	2	PUR1227	Fender Washer 5/16"
22	10	PUR1275	Locknut 5/16" Nylock
23	2	PUR1273	Center Locknut 5/16"
24	1	PUR1272	Locknut 3/8" Nylock
25	1	PUR1215	Eye Bolt 1/4" x 1 3/4"
26	1	PUR1265	Locknut 1/4" Nylock
27	1	PUR1489	Linkage Rod Assembly
28	1	PUR1485	Cable / Manual Lift
29	1	CYC4766	Lift Handle Bottom
30	1	PUR1492	Lift Strap

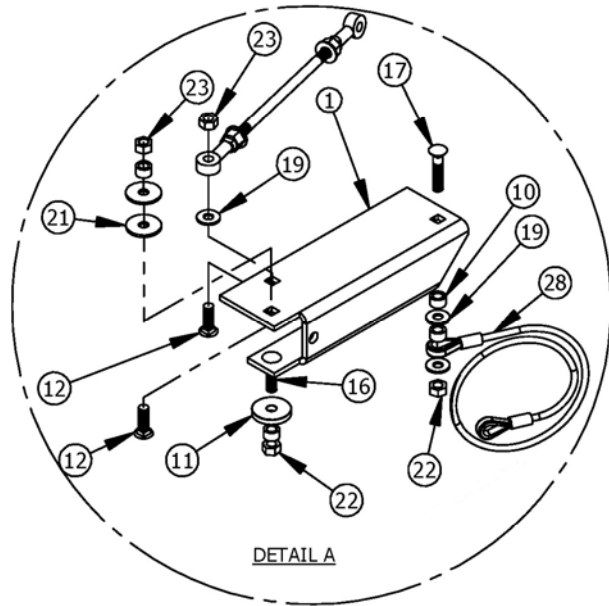

PARTS ORDERING INFORMATION:

Replacement fasteners are common-type and can be purchased locally. Use minimum Grade 3 galvanized fasteners.

BEFORE YOU BEGIN:

- Please read and understand all instructions.
- Verify all parts and tools are accounted for.
- To ensure a satisfactory installation, follow all steps correctly and in the sequence described.
- All directions referring to right and left are when the rider is sitting on the machine

TOOLS REQUIRED:

- Basic Hand Wrench and Socket Set
- Torque Wrench
- Needle-nosed Pliers

NOTE:

Kit 15-0015 is used with 15-0001
Standard-Duty Push Tubes Only

Kit 15-0015 is recommended for 60" or
smaller plow blades only, and is not to be
used with V-plow or Commercial Plows.

INSTALLATION NOTES:

The steps for installation assume that you have already assembled the blade and push tube and have a mount installed on your ATV. If you have not assembled these components, please refer to your mount, blade and push tube assembly instructions. You may also assemble this kit by placing the push tube on a work bench.

For ease of installation, standing the assembled blade and push tube vertically as shown is recommended.

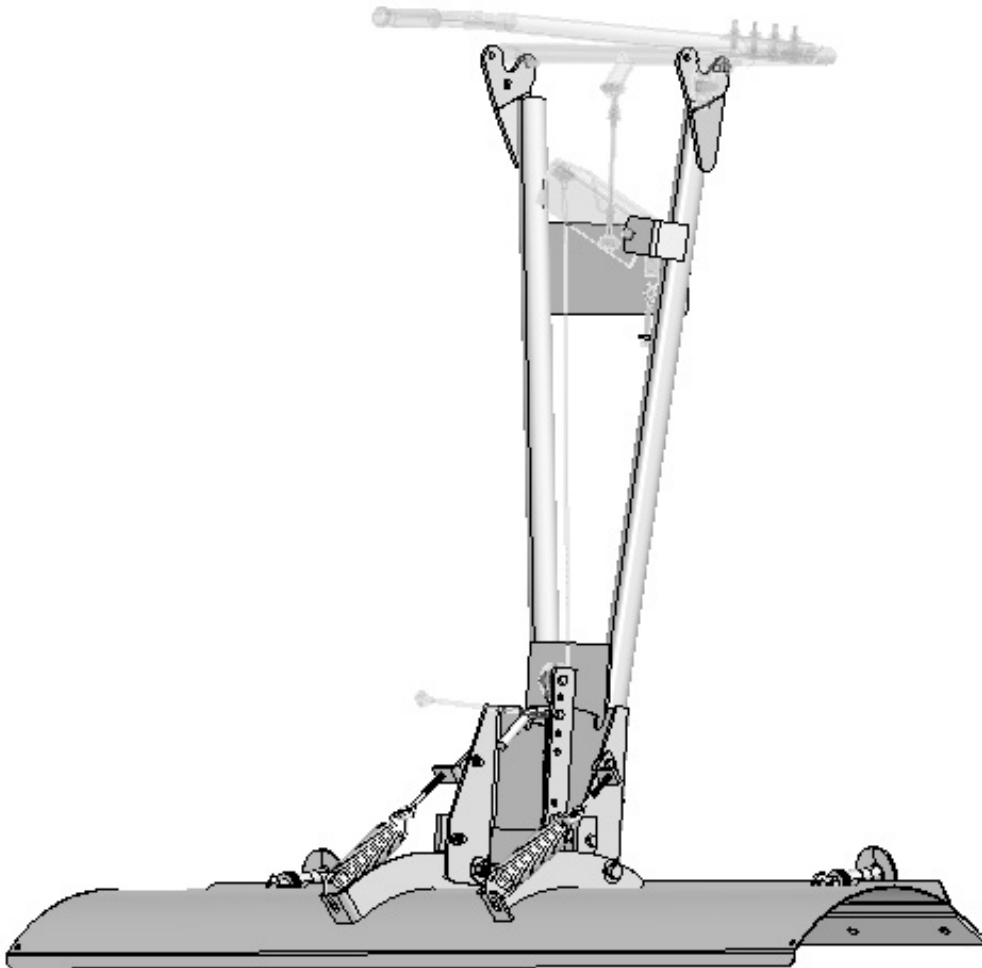

ASSEMBLY INSTRUCTIONS:

1. Install the link channel, Item #1, onto push tube 15-0001 as shown in Illustrations 1A, 1B, and 1C. Pay particular attention to the correct order of parts to be assembled. Torque nuts, Item #23 and Item #22, to specification.

NOTICE

Install spacers and fasteners exactly as shown in Illustrations 1A and 1B



= T

Item #23, Item #22 - 5/16" FASTENER TORQUE:
12ft. lbs. (16.2 Nm)

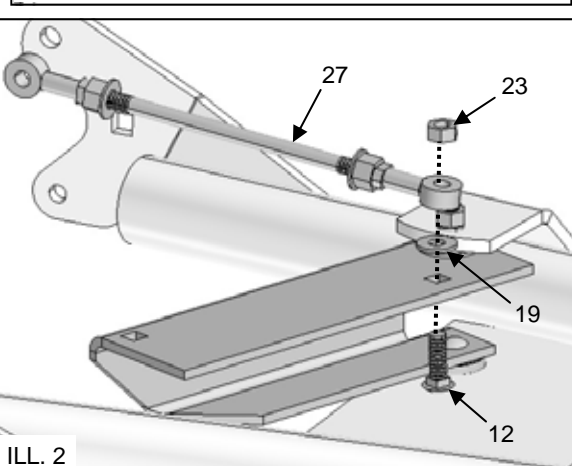
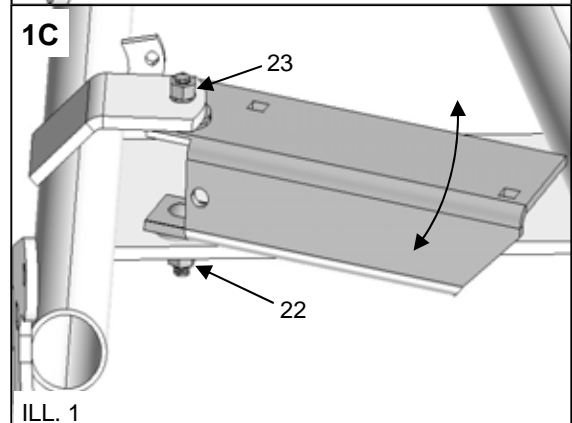
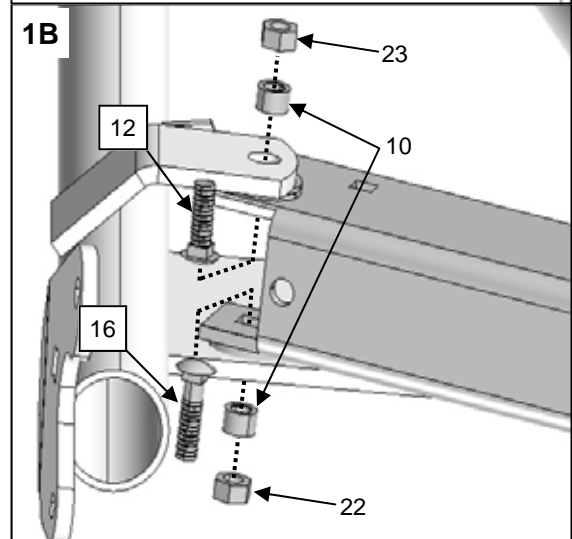
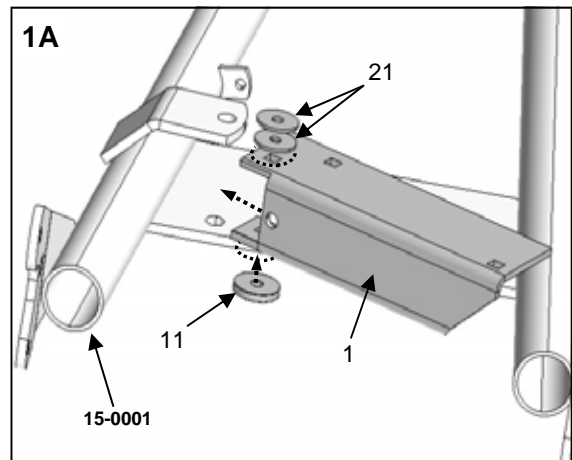

2. Place washer, Item #19 onto the link channel as shown and install the link rod assembly, Item #27. Fasten with bolt, Item #12 and lock nut, Item #23. Torque to specification. See Illustration 2.



= T

Item #23 - 5/16" FASTENER TORQUE:
12ft. lbs. (16.2 Nm)

- Place spring, Item #2, onto the lever assembly as shown in Illustration 3. Install eyebolt, Item #25 and fastener, Item #26 onto the tab of push tube 15-0001. Initial setting of the locknut is about half-way up the eyebolt.

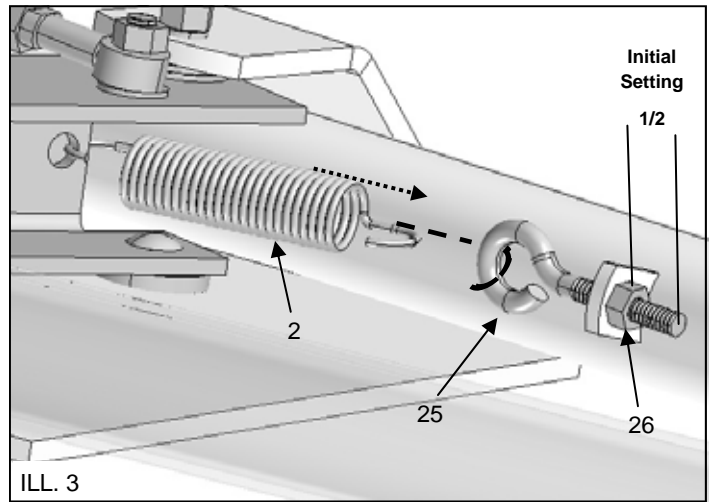

- Assemble lever stop Items #6, #14, #18, #20, and #24 to push tube 15-0001 as shown in Illustration 4.

 = T
Item #24 - 3/8" FASTENER TORQUE: 17ft. lbs. (23 Nm)
Torque Fastener After Lever Stop Adjustment

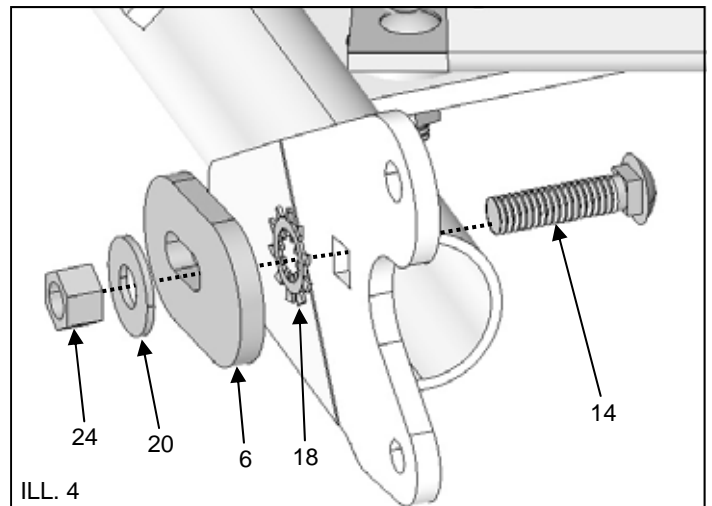

- Assemble the lower lift handle, Item #29, to the push tube and link rod using Items, #13, #19, #10 and #22 as shown in Illustration 5. Torque fasteners to specification.

 = T
Item #22 - 5/16" FASTENER TORQUE: 12ft. lbs. (16.2 Nm)

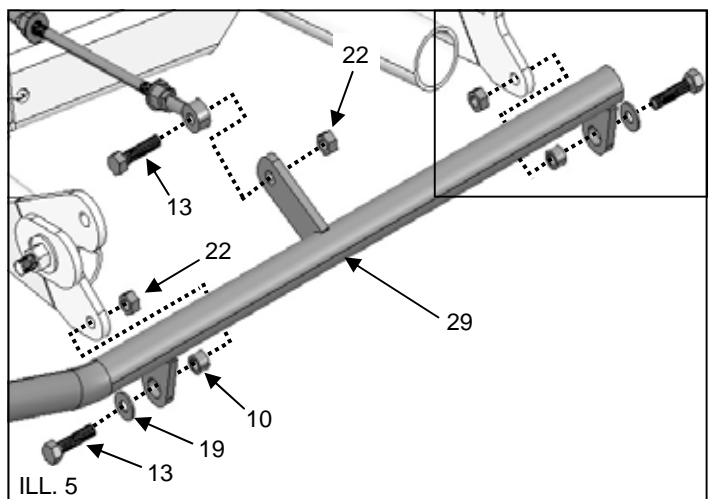

- Attach the lift cable, Item #28 to the link channel using Items #17, #10, #19 and #22 as shown in Illustration 6. Pay attention to part orientation. Torque fastener to specification.

 = T
Item #22 - 5/16" FASTENER TORQUE: 12ft. lbs. (16.2 Nm)

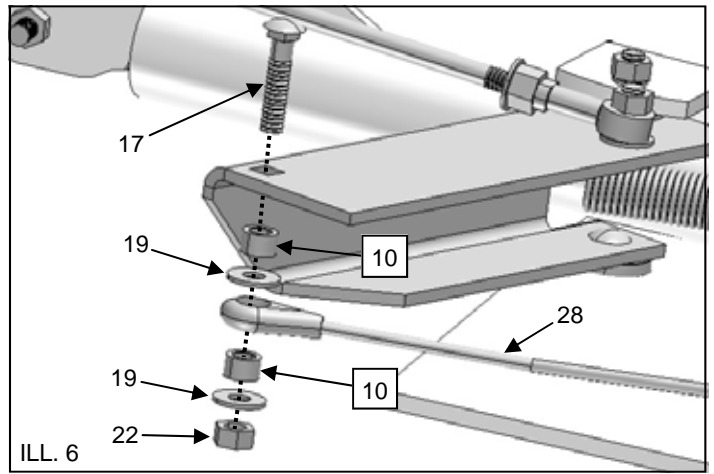

ILL. 6

- Install pulley, Item #9 onto the push tube lever bracket as show in Illustration 7. *Do not tighten fastener at this time.*
- Insert lift cable, Item #28, between the cable guide, Item #7, and under the pulley as shown in Illustration 7. Torque fastener, Item #22, to specification.

 = T
Item #22 - 5/16" FASTENER TORQUE: 12ft. lbs. (16.2 Nm)

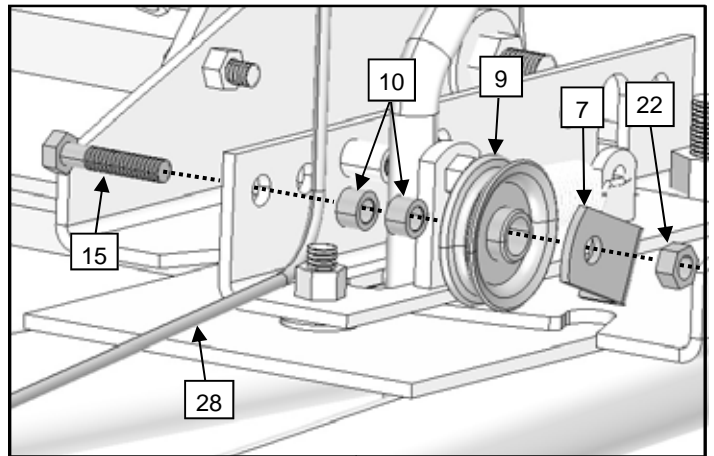

ILL. 7

- Install upper lift handle, Item #3, to the lower lift handle using tube clamp, Item #4. Fasten with Items, #17, #19 and #22. Hand-tighten item #22 sufficiently, using care not to over-tighten the tube clamp assembly. Place thread caps, Item #5, over the exposed ends.

NOTICE
ITEM #17
Point threaded ends away from the front of the machine to avoid component damage
See Illustration 8

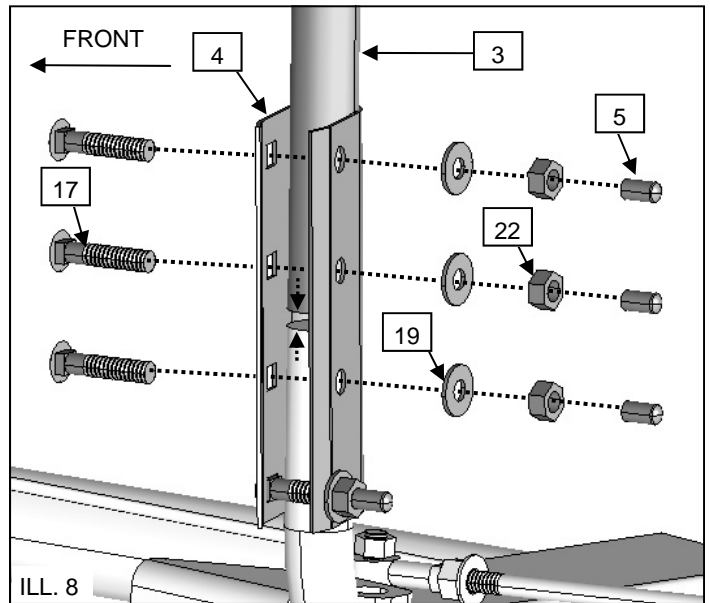

- Install handle grip, Item #8. See Illustration 9.

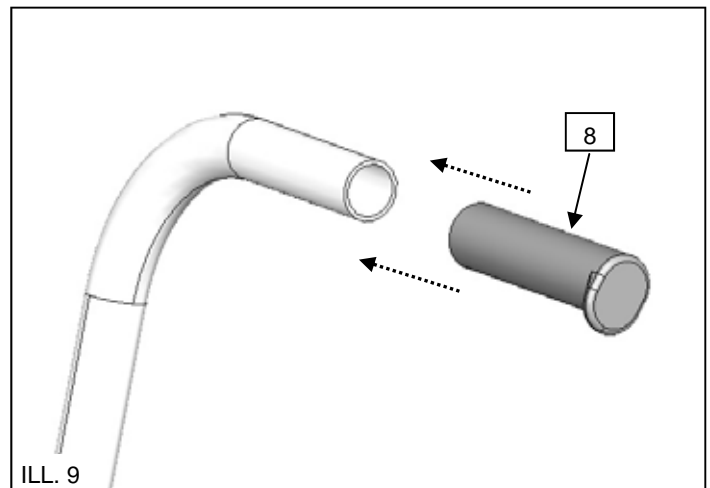

MANUAL LIFT / PUSH TUBE INSTALLATION and ADJUSTMENTS:

- Position the push tube assembly in front of the ATV. See Illustration 10.
- Drive or push ATV forward over the lift handle. Continue forward until the push tube attaching tabs are centered under the mounting tabs. Attach the push tube to the using the clevis pins and hair pins that came with the mount kit. See Illustration 10.

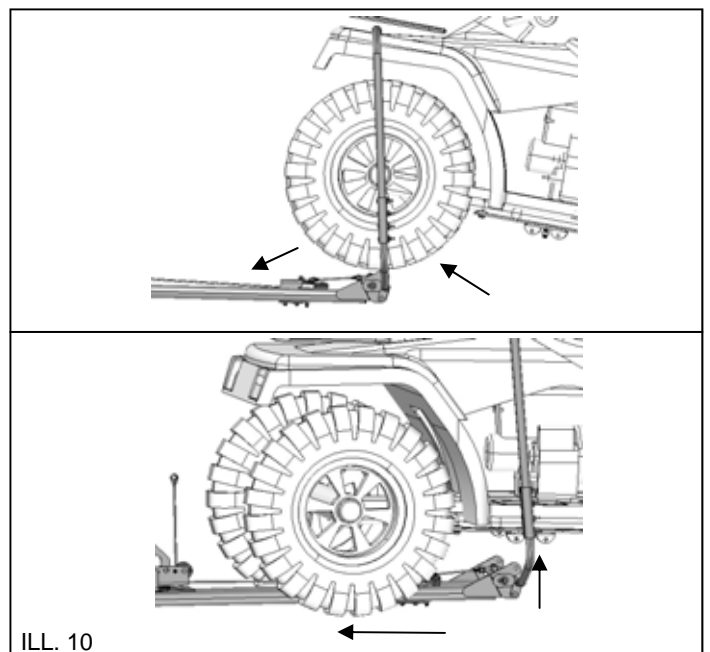

- Place the ATV front tires onto 1-1/2" (3.81cm) boards or other suitable material (Upon strap installation, this will allow the blade to 'float' up and down with changes in terrain). See Illustration 11.

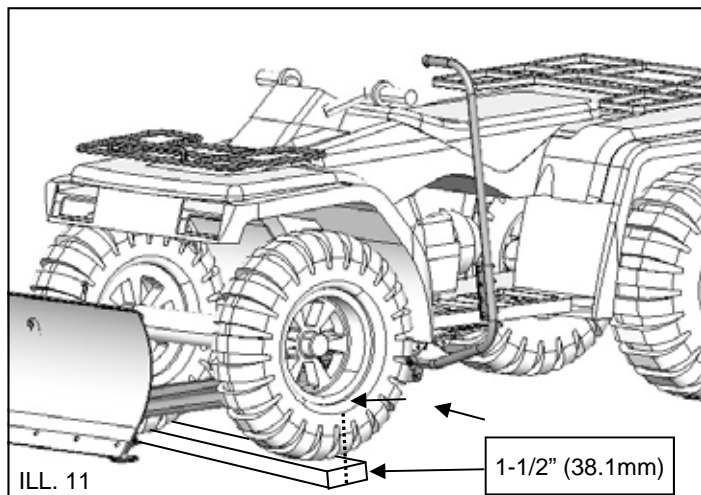

- Push the lift handle into the forward position until it is approximately 1/2" (1.27 cm) from contacting the forward-most component of the ATV. See Illustration 12.

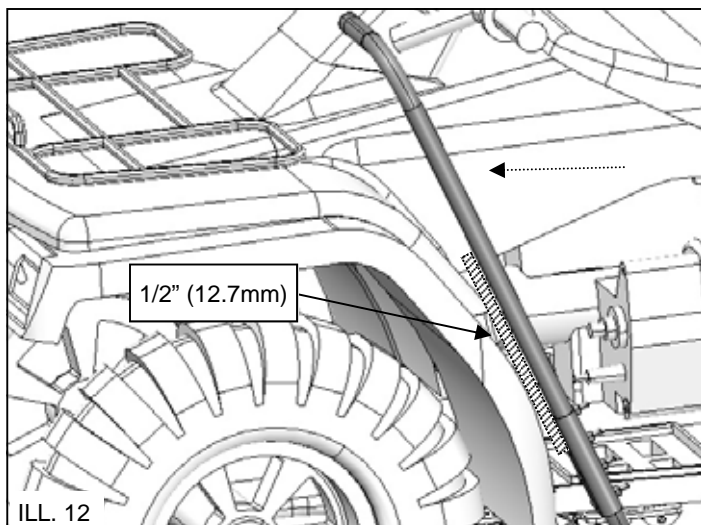

- Adjust the lever stop against the lower lift handle and torque the fastener to specification. See Illustration 13.

 = T
Item #24 - 3/8" FASTENER TORQUE: 17ft. lbs. (23 Nm)
Torque Fastener After Lever Stop Adjustment

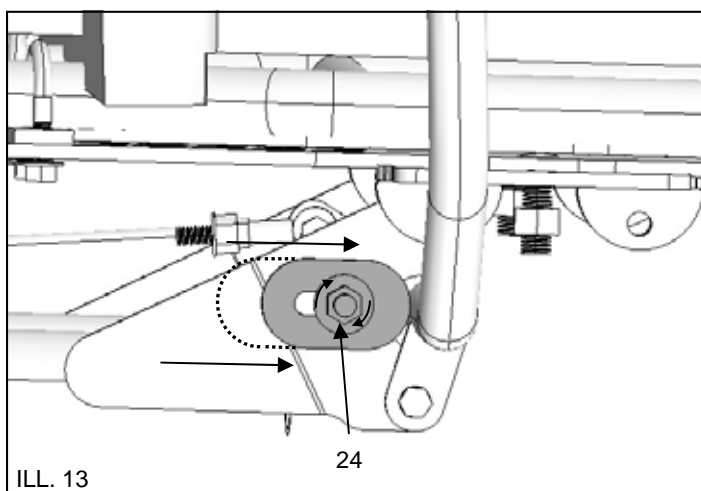

6. The lift strap must be secured to the ATV in a manner that allows it to support the push tube and blade weight, and also be as straight above the pulley as possible. Attaching the strap to a bumper or rack (See Illustration 15) is recommended.
7. Assemble strap, Item #30, through the cable loop, the ATV and back through the buckle, making sure the buckle is positioned at the top as shown in Illustration 14.
8. With the lift handle in full-forward, pull the strap tight, taking all slack out of the cable and strap.

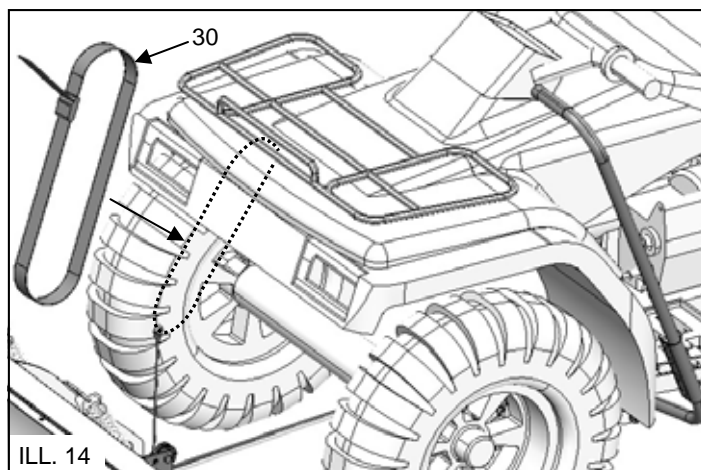

FINAL ADJUSTMENTS:

UP Lock Feature - Lift the blade using the lift handle. The lever should lock into the 'UP' position just as the lever comes near the rear fender.

If the lift handle contacts the rear fender or does not lock:

- Shorten the link rod length, Item # 27.

If the lift handle locks too soon or travel is too short:

- Lengthen the link rod length, Item # 27.

NOTICE

Link Rod Adjustment:

Any adjustment requires strap, Item #30, to be re-set.

Lift Handle Interference - The upper lift handle is the correct length for most ATVs to avoid contact with the handlebars, however, check for possible interference by slowly pulling the lift handle back while turning the handlebar until the two components intersect at their closest point.

If the lift handle is too close or contacts the handlebar:

- Raise the handlebar height.
- The upper lift arm length, Item #3, may be shortened. Remove the upper lift arm from the tube clamp, trim to the desired length and reinstall.

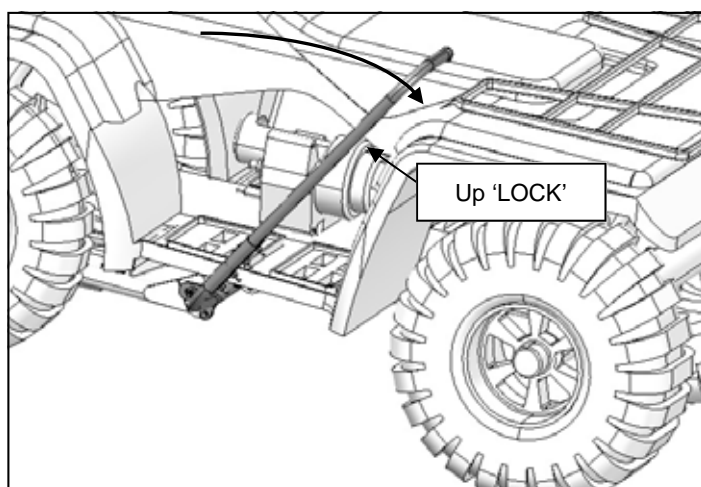

Blade Lift Height - Check the clearance between the bottom of the wear bar and the ground with the blade in the 'UP' position.

If the blade lift height is less than 3" (7.62 cm):

- Check the position of the lift handle in the 'UP' position. If there is excess clearance between the lift handle and the rear fender/rack of the ATV, the link rod may need to be lengthened. NOTE: Readjust the lift strap anytime the link rod is adjusted.
- Adjust the front suspension coils springs to the stiffest setting (if equipped) to reduce front-end 'sag' when the blade is lifted.
- Install coil spring spacers (if required) to reduce front-end 'sag' when the blade is lifted.



One Year Limited Warranty

For the period of one (1) year from the purchase date, Cycle Country Accessories Corporation will replace for the original purchaser, free of charge, any part or parts found upon examination by Cycle Country Accessories Corporation to be defective in material, workmanship, or both.

All transportation costs incurred submitting product to Cycle Country for warranty consideration must be borne by the purchaser. If Cycle Country determines that the product must be returned to the factory for credit, please call 1-800-841-2222 for a Return Merchandise Authorization (RMA) number and shipping instructions.

This warranty does not apply to parts that have been damaged by accident, alteration, abuse, improper maintenance, normal wear, or other causes beyond the manufacturer's control. In order to protect you and your ATV, certain parts of the plow system and/or hardware are designed to fail when the equipment is over-stressed.

Peripheral products such as engines, electric motors, and actuators may carry an original manufacturer's warranty. Please call Cycle Country Accessories Corporation for more information.

CYCLE COUNTRY ACCESSORIES CORPORATION

1701 38TH AVE W

PO BOX 257

SPENCER, IA 51301

SERVICE: 800-841-2222 FAX: 712-262-0248

E-MAIL: ccac@cyclecountry.com

WEB: www.cyclecountry.com