



DRIVE IN X-CHANGE

TRIPLE PLAY Patent Pending - Blade Attachment Kit

ASSEMBLY / OWNER'S MANUAL

Part No: 15-0310

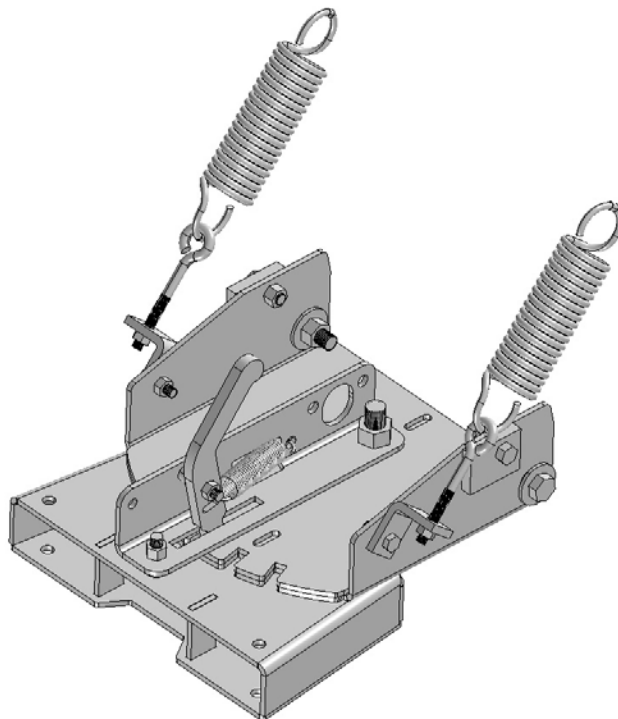

OPERATING INSTRUCTIONS

Congratulations! You've just purchased the most durable accessory component in the industry. Cycle Country accessories work great summer or winter. With proper care and maintenance, your Cycle Country accessory will last for years to come!

NOTICE
<p>The Drive In X-Change™ system requires a Triple Play Blade Attachment and one or more of these components to fully function:</p> <ul style="list-style-type: none">• Triple Play Push Tube• Drive In X-Change™ Accessories

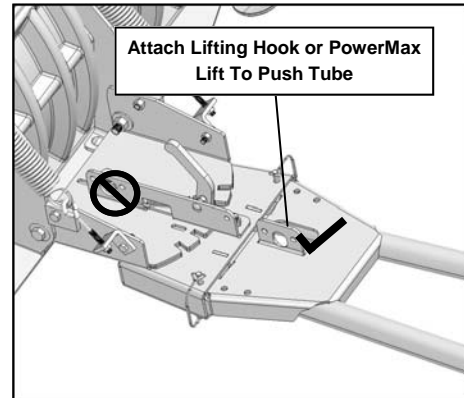

Please read and understand all assembly instructions, notices and warnings before assembling and operating your accessory.

Follow these guidelines to ensure satisfactory operation:

- Periodically check for wear and tightness of all fasteners. Replace or re-torque fasteners as necessary.
- Read this manual and your ATV operators manual before use.
- Before first use, set plow in the furthest right or left angled position to check for interference with the vehicle.
- Operate with extreme caution on slopes and rough terrain. Be familiar with the area before you plow.
- Be aware of immovable objects that could be hidden in the dirt, gravel or snow you are plowing.
- To avoid damage when plowing dirt, gravel or snow into a pile, reverse direction before raising the plow blade.
- Do not ram the plow into piles of dirt, gravel or snow, as damage to the plow system or vehicle may result.

A complete operator's guide can be downloaded for free at www.cyclecountry.com. This guide contains beginner-to-advanced information regarding plow systems and operation.

SAFETY INFORMATION

Cycle Country accessories were designed with your safety in mind. In order to protect you and your vehicle, certain parts of the accessory and/or hardware may be designed to fail when the equipment is over-stressed.

 WARNING
<p>To avoid personal injury or damage to your vehicle:</p> <p>Do not exceed 5 mph (8 kph) with the blade installed</p> <p>Be aware that vehicle ground clearance is reduced with plow system installed</p> <p>Keep yourself, other people and pets away from the blade and moving parts during operation</p> <p>Before adjusting blade angle or disconnecting the plow system, stop the engine and set the parking brake</p> <p>Remove your plow system before trail riding</p> <p>Do not ram the plow system into piles of dirt, gravel or snow</p>

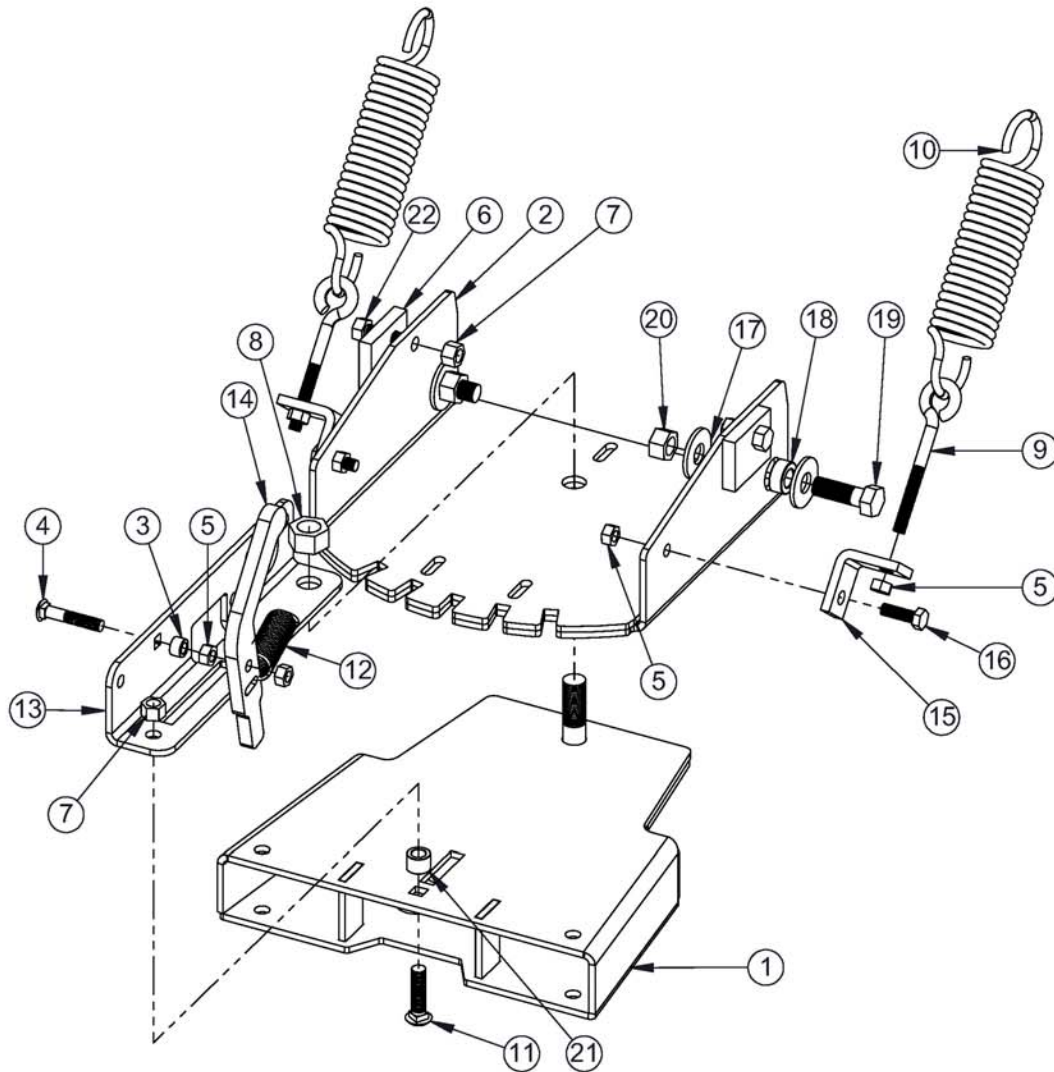

Model Number 15-0310 Parts List

ITEM NO.	QTY.	PART NO.	DESCRIPTION	ITEM NO.	QTY.	PART NO.	DESCRIPTION
1	1	CYC6019	DIXC QAB Weldment CC	12	1	PUR1437	Spring
2	1	CYC2065	Blade Hinge Weldment	13	1	CYC2070	Lever Bracket
3	1	PUR1360	Sleeve Bushing	14	1	CYC2069	Lever
4	1	PUR2422	5/16" x 1 3/4" Carriage Bolt	15	2	CYC0812	Blade Spring Bracket
5	6	PUR1275	Locknut 5/16" Nylock Clear Zinc	16	2	PUR1155	5/16" x 1" Bolt
6	2	CYC0813	Blade Stop	17	4	PUR1235	Flatwasher 1/2"
7	3	PUR1272	Locknut 3/8" Nylock	18	2	PUR1411	Bushing
8	1	PUR1283	Locknut 5/8" Nylock	19	2	PUR1110	Bolt 1/2" x 1-1/2"
9	2	PUR1216	Eye Bolt 5/16" x 4-1/4"	20	2	PUR1261	Nut 1/2" Nylock
10	2	PUR1409	Blade Spring	21	1	PUR2424	Bushing .385" x .625" x .450"
11	1	PUR1186	Carriage Bolt 3/8" x 1-1/2"	22	2	PUR1140	3/8" x 1" Bolt

PARTS ORDERING INFORMATION:

**Replacement fasteners are common-type
and can be purchased locally. Use minimum
Grade 5 zinc-coated fasteners.**

BEFORE YOU BEGIN:

- Please read and understand all instructions.
- Verify all parts and tools are accounted for.
- To ensure a satisfactory installation, follow all steps correctly and in the sequence described.
- All directions referring to right and left are when the rider is sitting on the machine

TOOLS REQUIRED:

- Basic Hand Wrench and Socket Set
- Torque Wrench
- Needle-nosed Pliers

INSTALLATION NOTES:

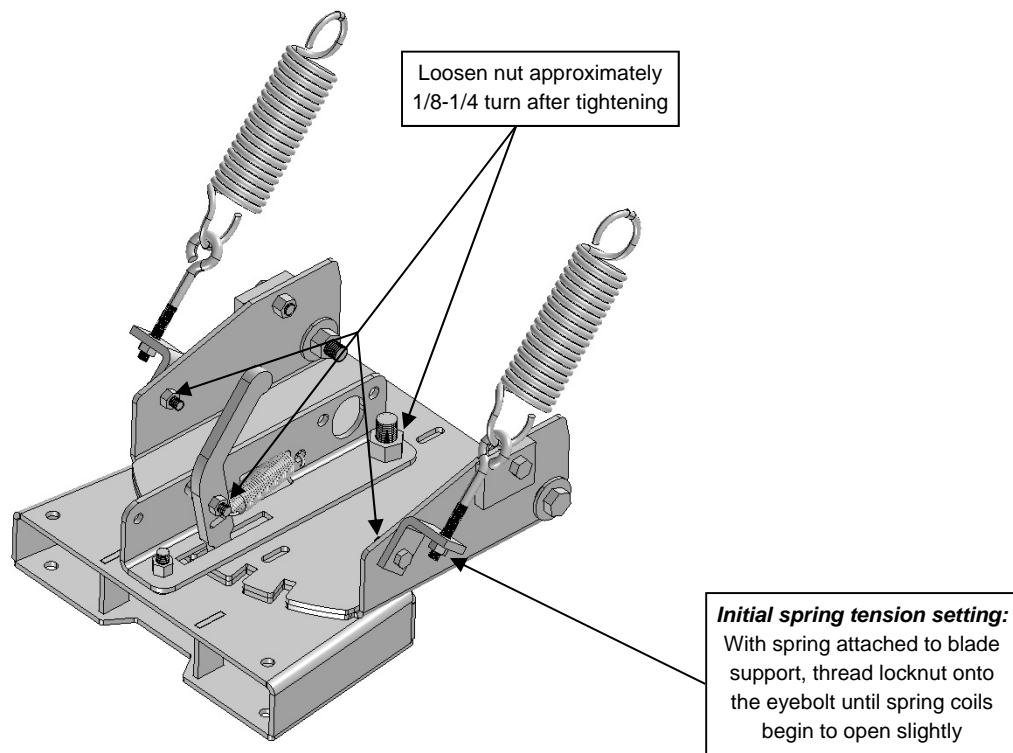

ASSEMBLING THE BLADE ATTACHMENT:

1. Assemble the lever bracket as shown in Illustration 1.

NOTICE

1A - Torque inside nut, Item #5, to
12ft. lbs. (13.5 Nm)

NOTICE

1B - Tighten outside nut, Item #5, then back out 1/8
-1/4 turn to allow lever, Item #14 to pivot freely

NOTICE

1B - Lever can be installed in either direction
that offers the most clearance for operation.

NOTICE

1C - Install Lever Spring, Item #12

1A

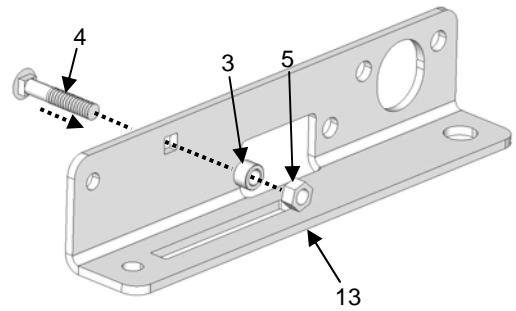

1B

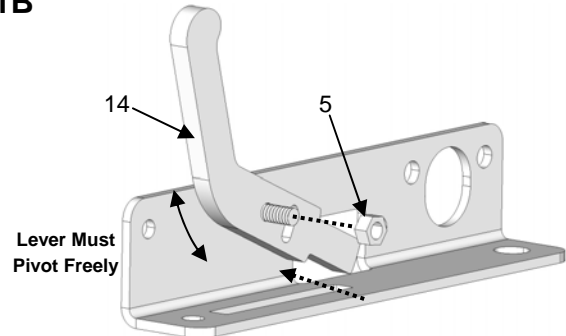

1C

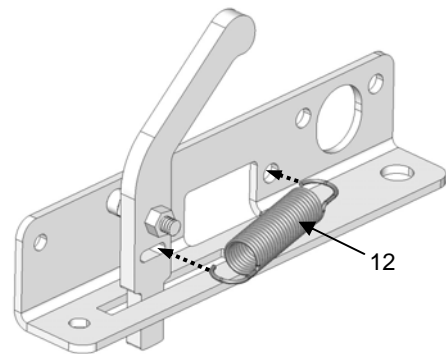

ILL. 1

2. Place hinge pivot bracket, Item #2, onto the quick attach bracket weldment, Item #1, as shown in Illustration 2.

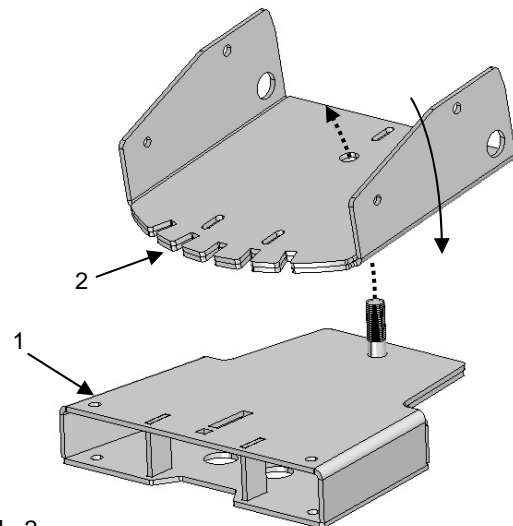

ILL. 2

- Place the assembled lever bracket, onto the quick blade attachment and pivot hinge as shown in Illustration 3.
- Install spacer, Item #21 and fasteners, Item #11 and #7. Torque to specification.

 = T
Item #7 - FASTENER TORQUE: 17ft. lbs. (23 Nm)

- Install Locknut, Item #8. See NOTICE.

NOTICE
Item #15 - Tighten lock nut, then back out 1/8-1/4 turn to allow blade hinge, Item #1 to pivot freely

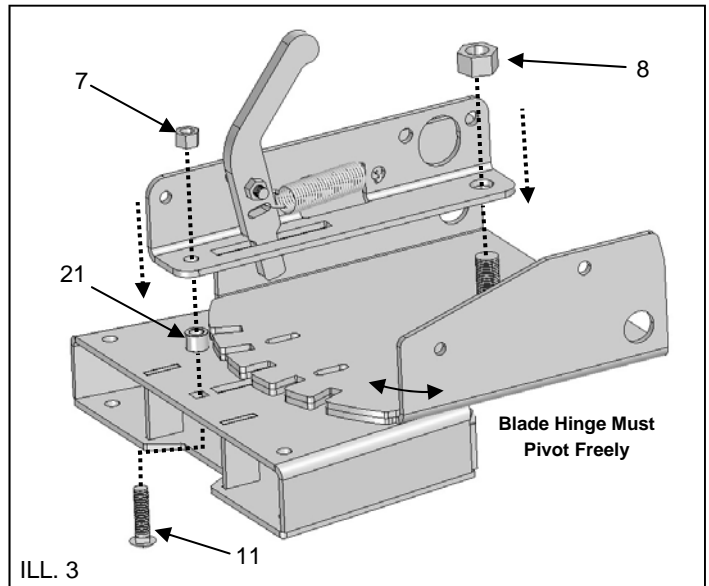

INSTALLING QUICK ATTACHMENT ASSEMBLY ONTO THE BLADE:

- Place bushings, Item #18 into the pivot hinge as shown. Attach the assembled push tube to a previously assembled blade. Place washers, Item #17 over the holes and fasten the push tube to the blade using bolts, Item #19 and locknuts, Item #20. See Illustration 4. Torque fasteners to specification.

 = T
FASTENER TORQUE: 50 ft. lbs. (67.7 Nm)

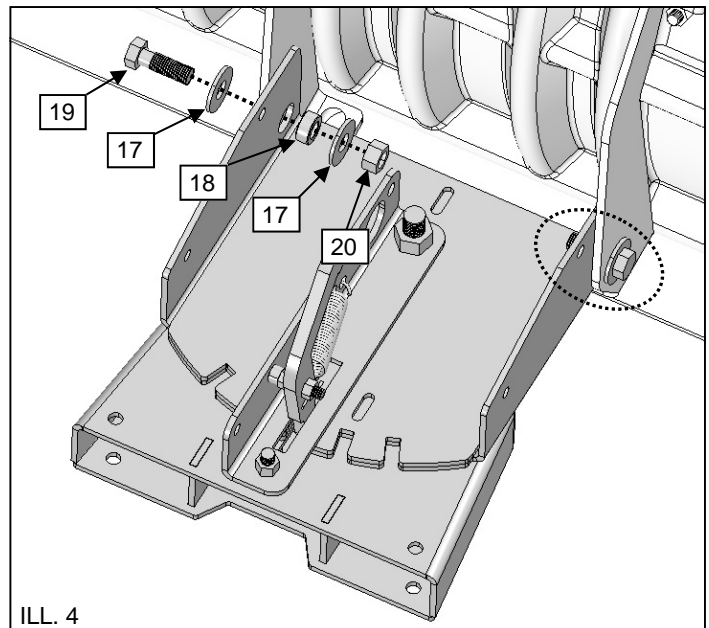

- Install the blade stops, Item #6. Fasten with bolts, Item #22 and nuts, Item #7. See Illustration 5. *Do not torque fasteners at this time.*

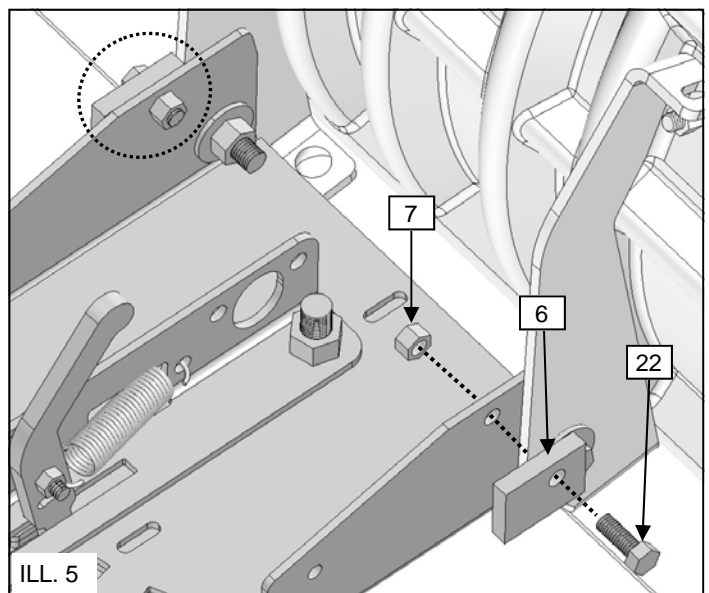

- Attach the blade spring brackets, Item #15, to the pivot bracket using bolts, Item #16 and nuts, Item #5. *Hand-tighten #5 sufficiently, then back-off 1/8-1/4 turn to allow bracket to pivot freely.* See Illustration 6.

NOTICE
Item #15 - Bracket must pivot freely

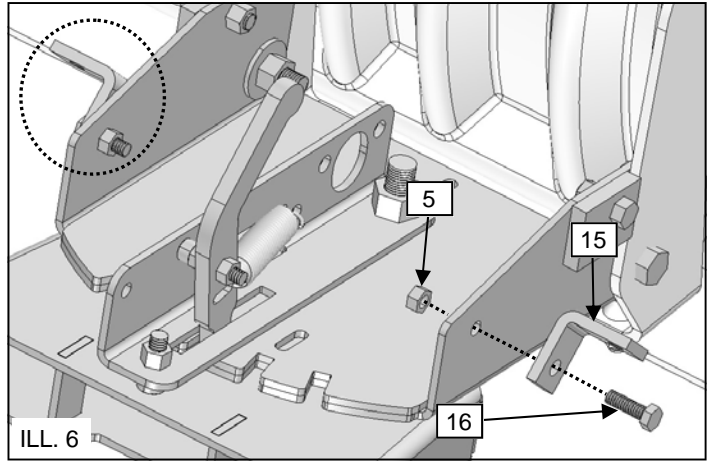

- Assemble blade springs, Item #10 and eyebolts, Item #9 between the blade assembly and spring brackets as shown in Illustration 7.

NOTICE
INITIAL BLADE SPRING TENSION: Refer to Installation Notes on Page 4

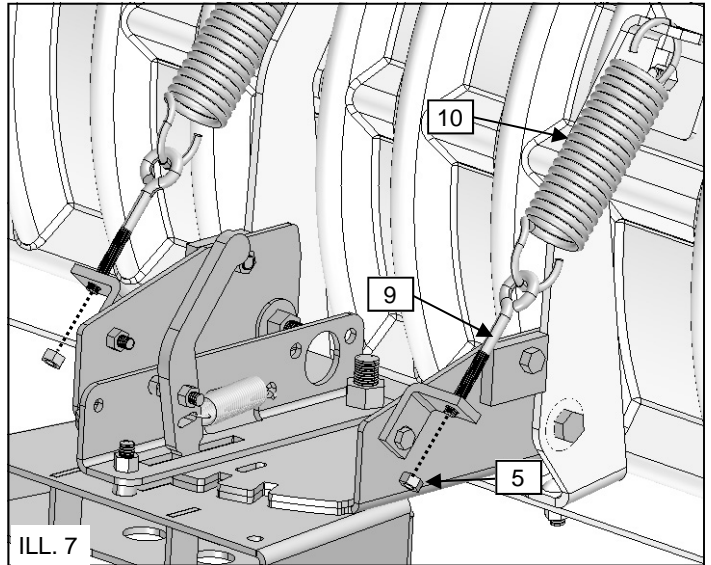

- Attach the assembled quick attach bracket system to a previously installed push tube kit on the vehicle. See page 7.

- Adjust the blade stops as desired to achieve best performance. Tighten the blade stop fasteners to specification once the desired position is obtained. See Illustration 8.

NOTICE
BLADE TILT / STOP ADJUSTMENT: Perform with plow system mounted on vehicle with blade in the down position. Refer to Installation notes on Page 4

 = T
FASTENER TORQUE: 17ft. lbs. (23 Nm)

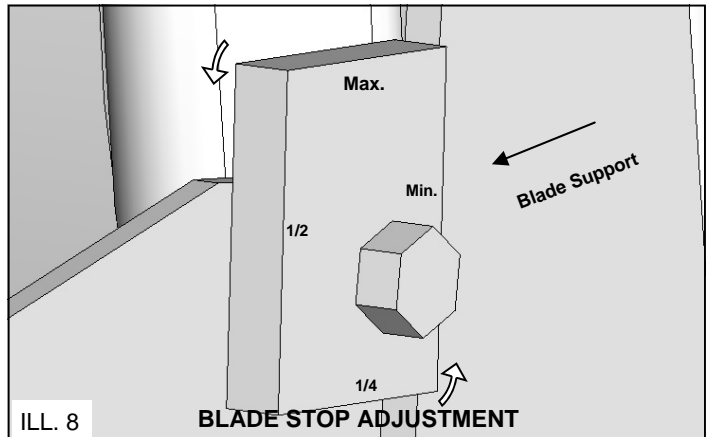

PUSH TUBE ENGAGEMENT:

1. Drive machine forward while directing the push tube forks into the attachment. **NOTE:** It may be necessary to lift the push tube slightly during engagement.
2. Lift the attachment off the ground and verify the lock pin holes are aligned.
3. Insert lock pins. See Illustration 9.
NOTE: Recommended lock pin installation is from the bottom side for easier removal and reduces the chance of catching on obstacles.

NOTICE

Stop engine and lock parking brake before dismounting the ATV to install lock pins

4. Attach winch hook or PowerMax Electric Lift to the push tube. See Illustration 9.
5. To disengage from the attachment, raise the push tube and remove the lock pins. Lower the push tube to the ground and back the machine away, pulling the push tube forks out of the attachment.

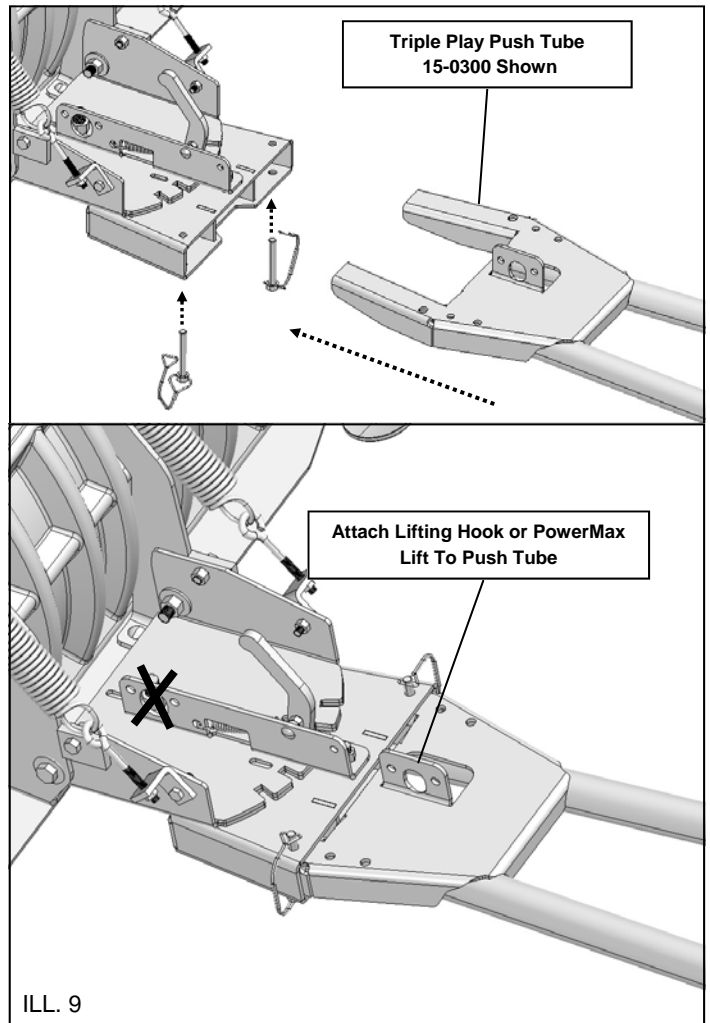



One Year Limited Warranty

For the period of one (1) year from the purchase date, Cycle Country Accessories Corporation will replace for the original purchaser, free of charge, any part or parts found upon examination by Cycle Country Accessories Corporation to be defective in material, workmanship, or both.

All transportation costs incurred submitting product to Cycle Country for warranty consideration must be borne by the purchaser. If Cycle Country determines that the product must be returned to the factory for credit, please call 1-800-841-2222 for a Return Merchandise Authorization (RMA) number and shipping instructions.

This warranty does not apply to parts that have been damaged by accident, alteration, abuse, improper maintenance, normal wear, or other causes beyond the manufacturer's control. In order to protect you and your ATV, certain parts of the plow system and/or hardware are designed to fail when the equipment is over-stressed.

Peripheral products such as engines, electric motors, and actuators may carry an original manufacturer's warranty. Please call Cycle Country Accessories Corporation for more information.

CYCLE COUNTRY ACCESSORIES CORPORATION

1701 38TH AVE W

SPENCER, IA 51301

SERVICE: 800-841-2222 FAX: 712-262-0248

E-MAIL: ccac@cyclecountry.com

WEB: www.cyclecountry.com