



QUAD BOSS PLOW MANUAL LIFT KIT OWNER'S MANUAL

This owner's manual covers all aspects of your new lift kit including assembly, replacement parts, installation, warranty, and troubleshooting. For any additional questions or concerns please call 877-847-1558 or visit www.quadboss.com.



Please read this entire owner's manual before assembling or installing!

QUADBOSS PLOW MANUAL LIFT REPLACEMENT PARTS

To order replacement parts for your manual lift, please call the Quadboss technical service department at 877-847-1558.

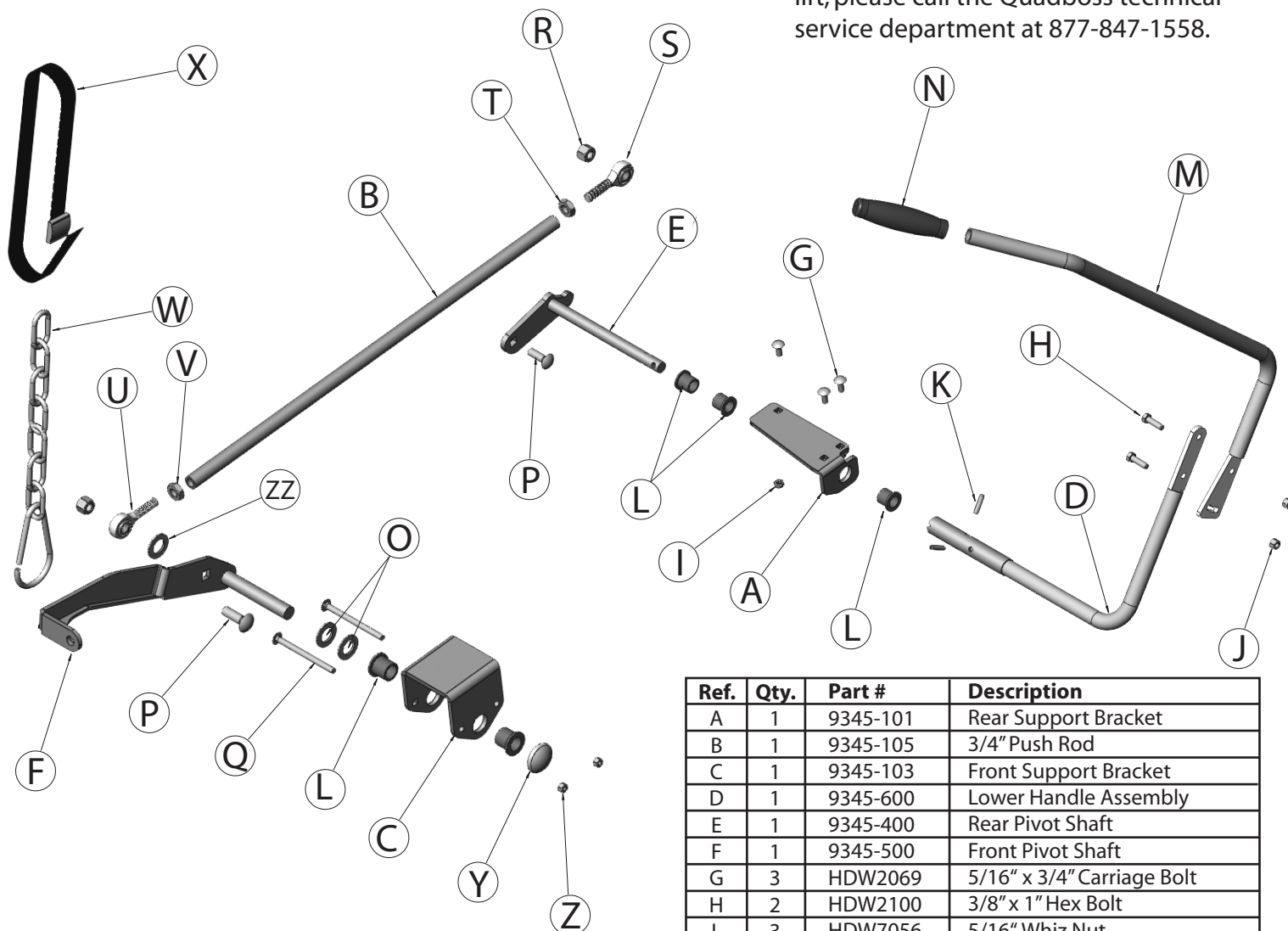

Ref.	Qty.	Part #	Description
A	1	9345-101	Rear Support Bracket
B	1	9345-105	3/4" Push Rod
C	1	9345-103	Front Support Bracket
D	1	9345-600	Lower Handle Assembly
E	1	9345-400	Rear Pivot Shaft
F	1	9345-500	Front Pivot Shaft
G	3	HDW2069	5/16" x 3/4" Carriage Bolt
H	2	HDW2100	3/8" x 1" Hex Bolt
I	3	HDW7056	5/16" Whiz Nut
J	2	HDW7060	3/8" Whiz Nut
K	2	HDW9220	5/16" x 1-1/5" Roll Pin
L	5	HDW2338	Bronze Flange Bushing
M	1	2610-76	Upper Handle
N	1	HDW4100	Handgrip
O	2	HDW9017	3/4" Flat Washer
P	2	HDW9222	1/2" x 1-3/4" Carriage Bolt
Q	2	HDW9221	5/16" x 4" Carriage Bolt
R	2	HDW7089	1/2" Nylock Nut
S	1	HDW9225	1/2" LH Thread Rod End
T	1	HDW9223	1/2" LH Thread Jam Nut
U	1	HDW9226	1/2" RH Thread Rod End
V	1	HDW9224	1/2" RH Thread Jam Nut
W	1	HDW654	Chain
X	1	HDW2341	Strap with Cambuckle
Y	1	HDW2331	3/4" Axle Cap
Z	2	HDW7058	5/16" Nylock Nut
ZZ	1	HDW9134	5/8" Lock Washer

QUADBOSS MANUAL LIFT ASSEMBLY

Install the Rear Support Bracket

1

First install a bronze bushing (L) (facing in) into each side of the large 1" holes in the back of the push tube. You may need to tap them into place with a rubber mallet. Locate the rear support bracket (A). It will line up with three holes on top of the rear of the push tube (under the pivot plate). Position the support bracket on top of the push tube with the formed end hanging DOWN on the LEFT side of the push tube (as you would sit on the ATV). Bolt in place from the top using three 5/16" x 3/4" carriage bolts (G) and 5/16" flange nuts (ZZ).

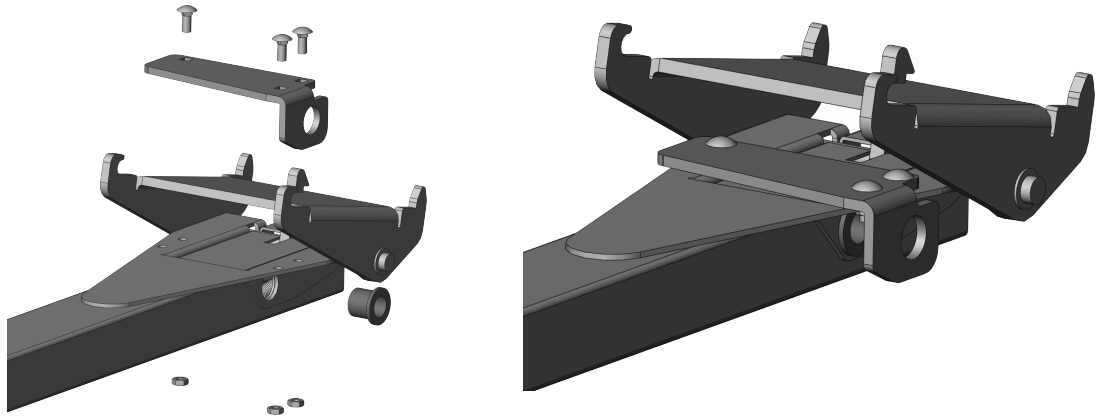

Install the Rear Pivot Shaft

2

The rear pivot shaft (E) slides into the rear support bracket installed in step 1. Install a bronze bushing (L) into the rear support bracket facing towards the push tube. You should now have three bronze bushings installed. Lightly grease the rear pivot shaft and slide in from the right side. The welded bracket on the pivot shaft should be facing downwards and forwards towards the plow blade. Verify the brass bushings did not slide out of place when installing the rear pivot shaft.

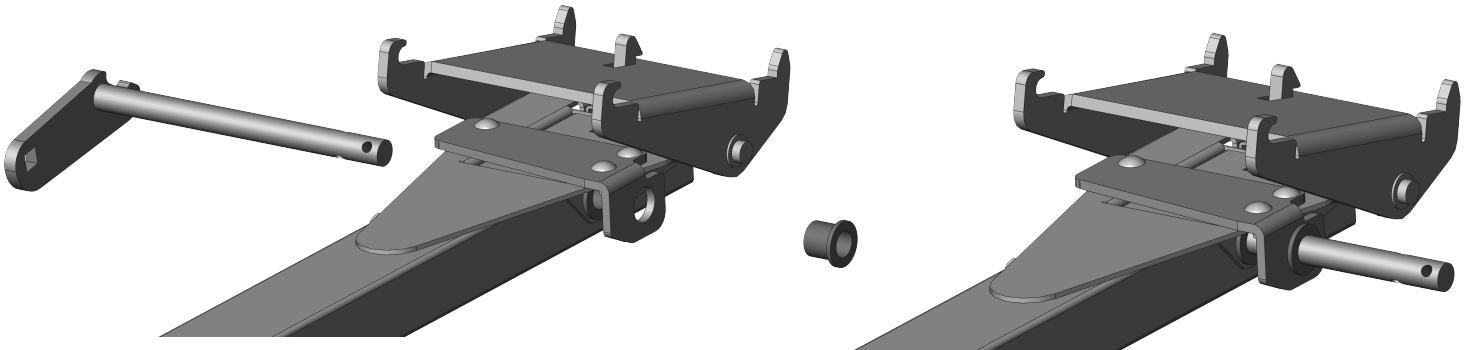

Install the Front U-Shaped Support

3

The front u-shaped support (C) will slide over the push tube (facing down) just behind the welded on support at the release handle. It must be positioned so the square bolt holes are on the right side of the push tube. Slide it in place behind the release handle, lift the handle up, and slide it forward underneath the handle and up against the welded supports. Install the two 5/16" x 4" carriage bolts (Q) from the right side underneath the support and secure with two 5/16" nylock nuts (Z) on the left side. Do not overtighten or it may warp the bracket and cause binding in the shaft.

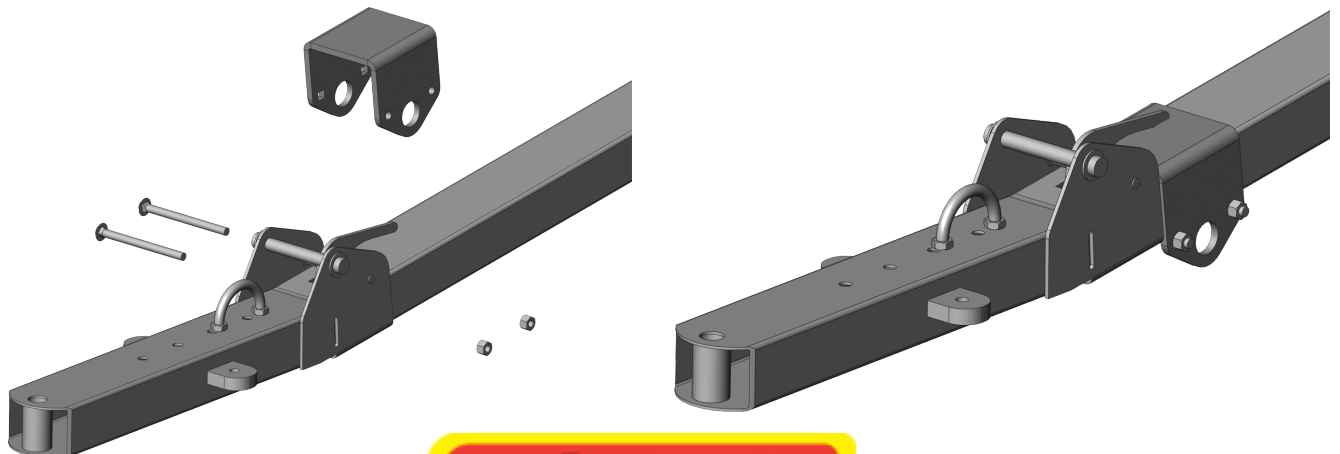

QUADBOSS MANUAL LIFT ASSEMBLY (Cont.)

Install the Front Pivot Shaft

4

Install a bronze bushing (L) (facing in) into each side of the u-shaped support brackets. Install two 3/4" washers (O) onto the front pivot shaft (F). Place a 1/2" x 1-3/4" carriage bolt (P) through the square hole in the side of the pivot shaft. It must be installed from the inside facing outward. Now slide the front pivot shaft with washers and carriage bolt through the bronze bushings in the front u-shaped support from the RIGHT side. The welded bracket should be facing forward towards the blade and be above the push tube. Lightly tap a 3/4" axle cap (Y) on the end of the shaft to secure it in place. Clip the end of the chain (W) into the hole in the end of the welded arm.

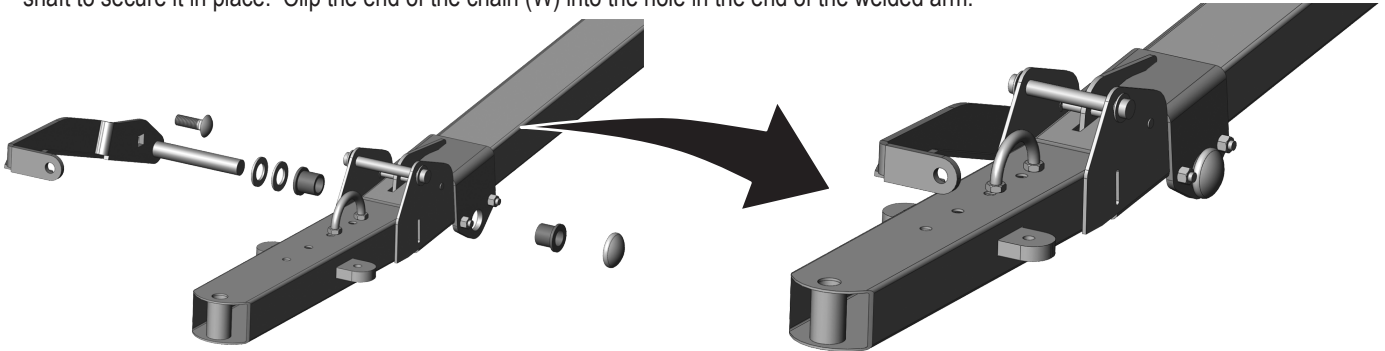

Install the Push Rod

5

Locate the left (S) and right (U) hand thread rod ends and jam nuts. Install the left hand thread jam nut (T) most of the way down the left hand thread rod end. Do the same for the right hand thread set. The push rod has left hand thread in one end and right hand thread in the other. Carefully install the correct rod end into each end. Install about 3/4 of the way down for now. You can leave these loose for now as you will be adjusting this push rod once installed on the ATV. Slide a 5/8" lock washer (ZZ) over the 1/2" carriage bolt sticking out of the front pivot shaft. Install a 1/2" x 1-1/2" carriage bolt (P) into the square hole in the rear pivot shaft. It must be positioned from the inside facing outward. Slide one end of the push rod assembly over the carriage in the rear pivot shaft and the other end over the carriage bolt and lock washer in the front pivot shaft. Secure with two 1/2" nylock nuts (R).

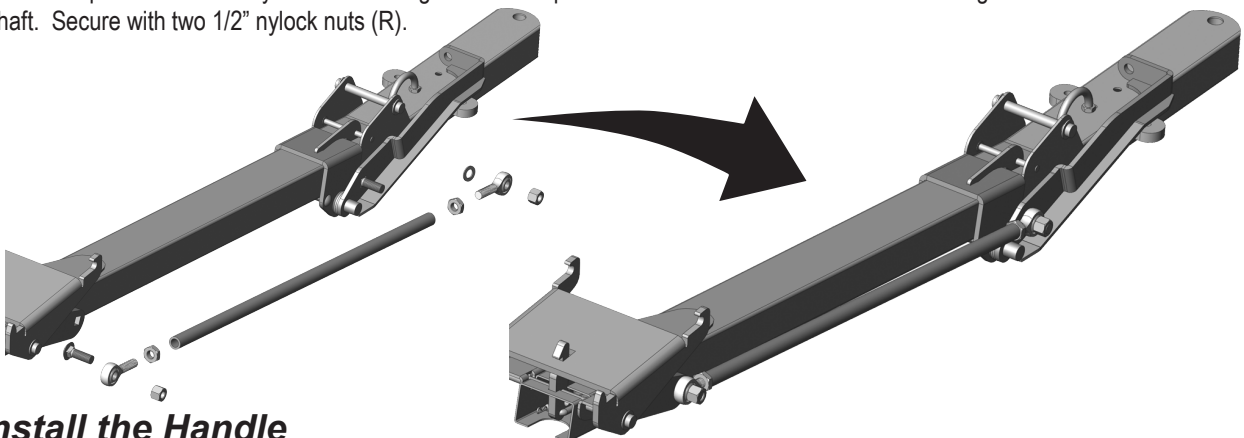

Install the Handle

6

Install the lower handle assembly (D) over the rear pivot shaft. There are two sets of intersecting holes that will line up with holes in the rear pivot shaft. Lightly tap a 5/16" roll pin (K) through each set of holes to secure the handle to the shaft. Bolt the upper handle assembly (M) to the lower handle assembly through the middle holes using two 3/8" x 1" hex bolts (H) and 3/8" whiz nuts (J). You may change the handle position later when adjusting on the ATV. Install the grip (N) onto the end of the handle.

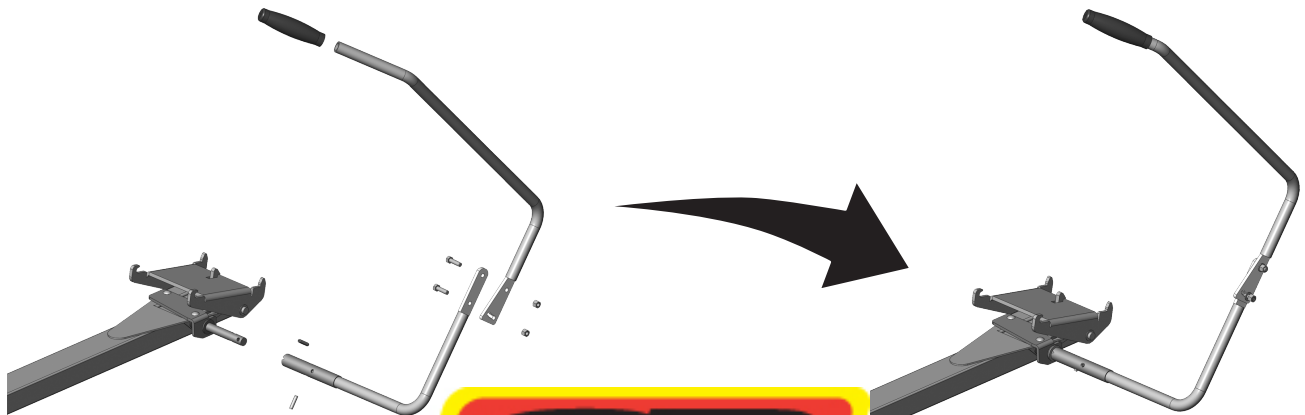

QUADBOSS MANUAL LIFT INSTALLATION

This push tube is designed to attach and detach easily from the front of the machine. The pivoting plate on the back of the push tube has two hooks on the front that attach to the front of the bottom mount plate. Once hooked in the front the blade can be pushed back to engage the locking lever on the pivot plate to the bottom mount. After a few tries this can all be done in one swift motion.

Installing onto the ATV

- 1 With the plow assembly on the ground and the manual lift handle facing forwards (in the down position), drive your ATV over the plow/handle and into position. Attach the nylon strap through one of the links in the chain and around your front rack or bumper. Tighten the strap until it is tight. Pull the lift handle so the plow lifts off the ground. The plow assembly should now be hanging free a couple inches off the ground by the front chain and strap. If not, lower the plow back to the ground, adjust the strap position, and try again. Ideally the front pivot plate hooks will be a couple inches in front of the welded rod on the front of the bottom mount.

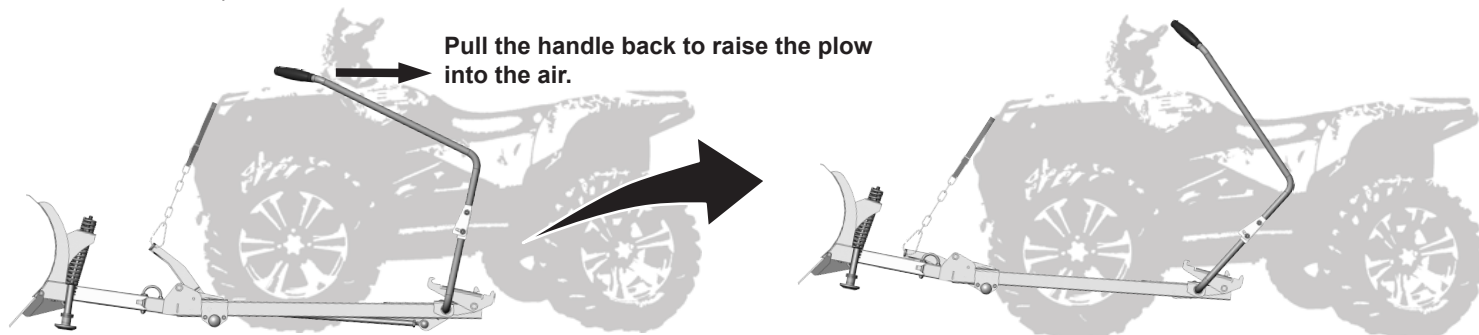

- 2 Once you have it raised in place and positioned properly in step 1, you need to attach the plow to the bottom mount. Standing in front of the plow, pull the system back towards the front of the machine a few inches then forcefully push it backwards in one swift motion until you hear/feel it click into place. It may take you a few tries the first time you do it until you get the "feel" for it. It may help to get the front hooks caught on the front rod first, then push the plow back/down to get the rear of the push tube to snap into place. **NOTE: Keep your feet positioned behind the plow while attaching to the ATV to prevent any possible accidents!**

Standing in front of the plow push the blade back so the front hooks attach to the crossbar on the mount and the rear snaps up into place.

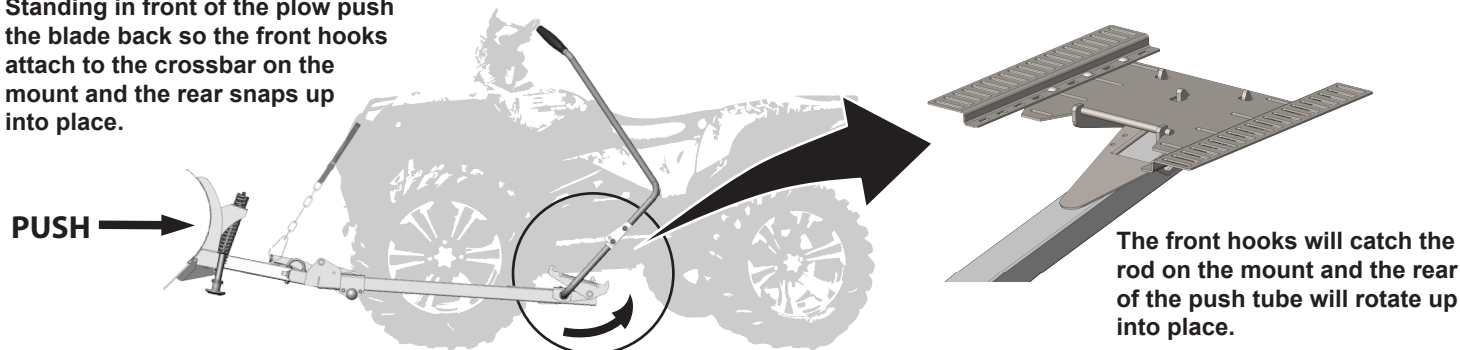

- 3 Visually look under the ATV to confirm the push tube has fully snapped into place. **NOTE: Failure to confirm the plow is securely attached could cause damage to your plow, ATV, or person!!** Move the lift handle forward and place the plow back on the ground. You are now ready to adjust the lift height.

The latch **MUST** be hooked over the bottom mount.

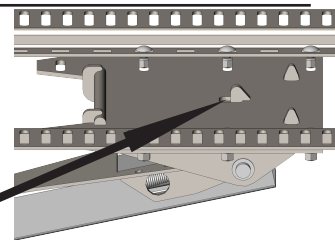

REMOVAL

- 1 To remove the plow system, move the lift handle forward so the blade is on the ground. Remove the strap and chain from the ATV. Simply pull the release lever on the push tube while pulling forward on the blade and the pivot plate will disengage from the mount. The plow system is quite heavy so it will drop to the ground with some force. Be careful not to pinch your fingers, toes, or anything else between the push tube and ground. You can now drive backwards over the handle and away from the plow.

Pull lever to release.

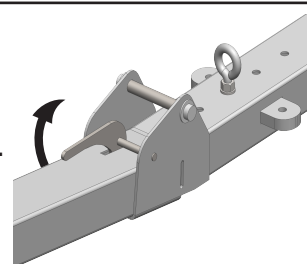

QUADBOSS MANUAL LIFT OPERATION/ADJUSTMENT

The information below explains the operation of the manual lift kit so you will have a better understanding of how to make adjustments for use with your particular ATV.

Operation

1

This manual lift kit operates via a push rod to lift your plow system. As you pull the handle back it forces the push rod forward which then forces the front pivot shaft down. Since the front pivot shaft is connected to the ATV via the chain and strap, this causes the plow to lift. At a certain lifting point the rear pivot shaft cams over and locks the plow in the upward position. Pushing the handle forward will release the cam over position and lower the plow system. Your lift height is generally limited by the push tube contacting the bottom of the ATV, this will usually be in the 5-10" lift height range.

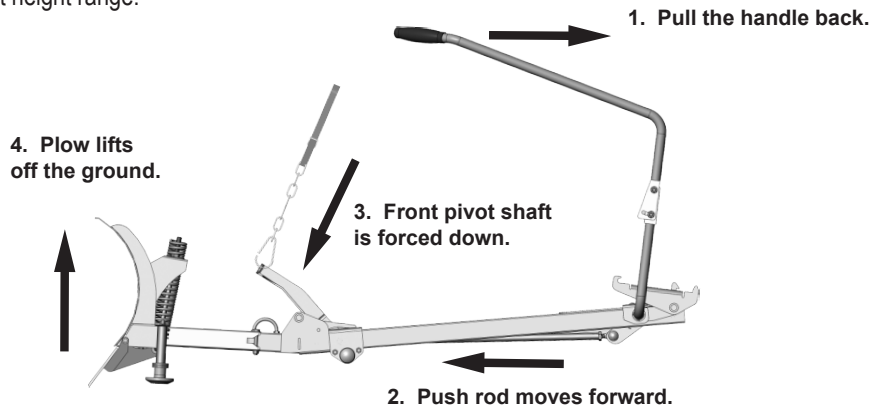

Adjustments

1

Once your plow with handlift is assembled you will want to adjust it for proper operation and maximum lift height. Remove if already installed on the ATV. With the plow assembly on the ground, put the handle all the way back. Ideally you want the front pivot arm (where the chain attaches) to rest on the push tube. Adjust the push rod in or out to achieve this. Tighten the jam nuts on the push rod.

Install the plow onto the ATV. Put the handle in the forward position with the blade on the ground. Now attach the chain/strap to the front rack or bumper and tighten until it is snug. Now test lifting the plow, if adjusted properly this will be your maximum lift height. The push tube should be very close to touching the bottom of the ATV. You can fine tune the adjustment with the push rod if required.

If the handle is contacting the front or rear fender you can adjust the position between the upper and lower handle assembly. There are three different positions that it can be adjusted to.

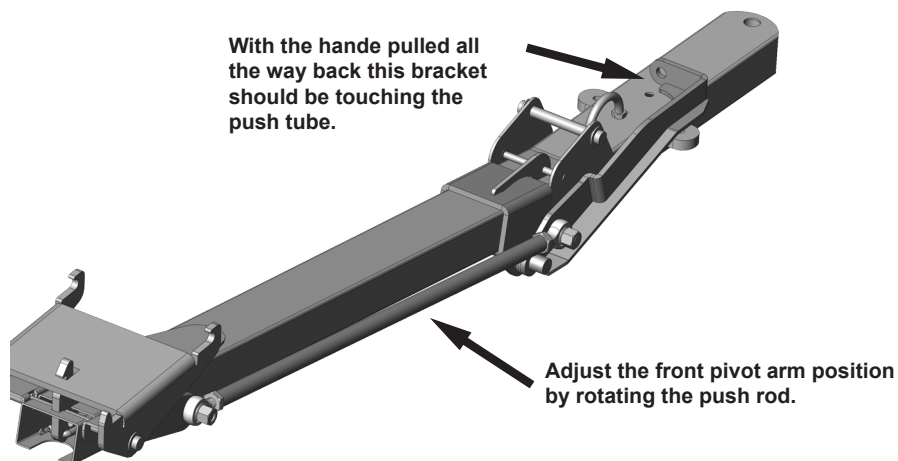

WARRANTY INFORMATION

The manufacturer's warranty to the original consumer purchaser is: This product is free from defects in materials and workmanship for a period of one (1) year from the date of purchase by the original consumer purchaser. We will repair or replace, at our discretion, parts found to be defective due to materials or workmanship. This warranty is subject to the following limitations and exclusions:

- 1) Commercial Use This product is not intended for commercial or rental use.
- 2) Limitations This warranty applies only to products which have been properly assembled, adjusted, designed by the original manufacturer to work in conjunction together, and operated in accordance with the instructions contained within this manual. This warranty does not apply to any product of Quad Boss, that has been subject to alteration, misuse, abuse, improper assembly or installation, or shipping damage.
- 3) Exclusions Excluded from this warranty are normal wear, normal adjustments, and normal maintenance. The blade and hardware were designed with safety in mind. To protect you and your ATV, certain parts were designed to fail when the equipment is over stressed. For this reason, the struts and related hardware are not warranted.

In the event you have a claim under this warranty, you must return the product to an authorized service dealer. All transportation charges, damage, or loss incurred during transportation of parts submitted for replacement or repair under this warranty shall be borne by the purchaser. Should you have any question concerning this warranty, please contact us at 877-847-1558. The model number, date of purchase, and name of authorized Quad Boss dealer from whom you purchased the product will be needed before any warranty claim can be processed.

THIS WARRANTY DOES NOT APPLY TO ANY INCIDENTAL OR CONSEQUENTIAL DAMAGES AND ANY IMPLIED WARRANTIES ARE LIMITED TO THE SAME TIME PERIODS STATED HEREIN FOR ALL EXPRESSED WARRANTIES.

Some states do not allow the limitation of consequential damages or limitations on how long an implied warranty may last, so the above limitations or exclusions may not apply to you. This warranty gives you specific legal rights and you have other right, which vary from state-to-state. This is a limited warranty as defined by Magnuson-Moss ACT of 1975.

